

#42024 MidTown Kit

Available exclusively at miniatures.com

Step-by-step assembly instructions

Copyright miniatures.com 2023

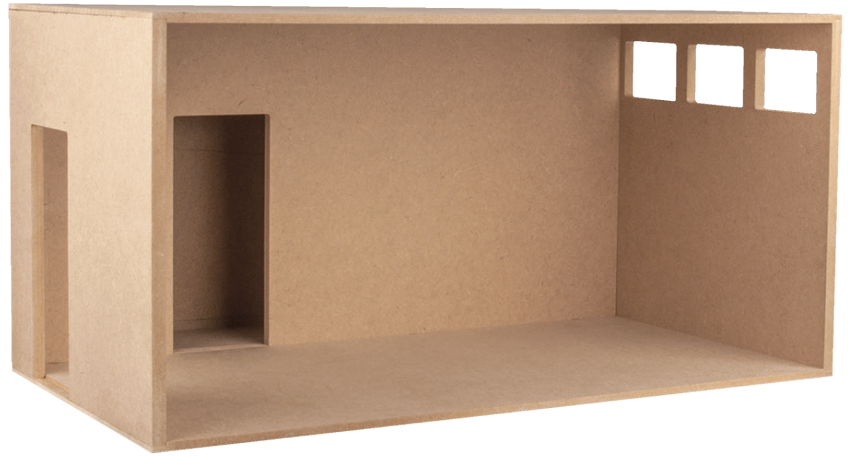

PARTS LIST:

Front Wall
 Left Wall
 Filler Strips (2)
 Base
 Back Wall
 Top
 Left Panel
 Floor Panel
 Right Panel
 Ceiling Panel
 Hinges (2)
 Magnets (2)

SUPPLIES NEEDED:

Masking tape
 White glue (such as #1249 Weldbond)
 Screwdriver
 Damp clean cloth
 Exterior and interior finishes

GENERAL INSTRUCTIONS

- Identify and inspect all parts using the Parts List.
- Read the directions completely before beginning the project.
- If possible, have a dedicated work area so that you are not unpacking, repacking, and moving the project from place to place.
- Choose a work surface that is level, clean, dry, and protected from spills.
- Do a dry fit, using masking tape to hold parts in place, to make sure everything fits together correctly before assembling permanently.

Assembly Instructions

Tip: Plan the finishes for the interior and exterior at the dry-fit stage, before final/permanent assembly. It is easier to finish the panels as flat surfaces. Disassemble and finish as desired, then reassemble using glue.

Shell Assembly

1. Glue and tape the **Front Wall** to the **Left Wall**. The **Left Wall** butts up against the **Front Wall**.
2. Glue and tape this corner assembly (from Step 1) to the **Base**. It fits into the rabbet grooves on the **Base**.
3. Glue a **Filler Strip** into each door opening.
4. Glue and tape the **Back Wall** to the **Left Wall** and to the **Base**.
5. Glue and tape the **Top** onto the assembly.
6. Let dry.

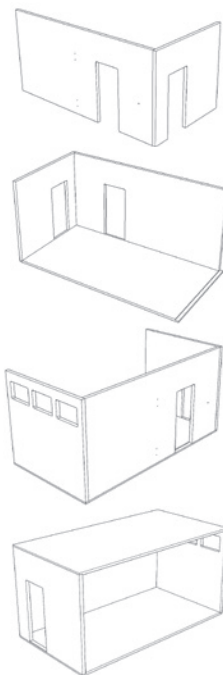

Bump Out Assembly

1. Glue and tape the **Left Panel** to the **Floor Panel**. The **Left Panel** fits into the rabbet groove on the **Floor Panel**. Orient the **Left Panel** such that the hinge holes are on the outside and away from the long rabbet groove of the **Floor Panel**.
2. Glue and tape the **Right Panel** to the **Floor Panel**. Orient the **Right Panel** such that the magnet hole is away from the long rabbet groove of the **Floor Panel**.
3. Glue and tape the **Ceiling Panel** to the **Left & Right Panels**.
4. Glue and tape the **Back Panel** in place. It fits into the long rabbet grooves on the **Floor** and **Ceiling Panels**. The **Back Panel** is wider than it is tall.
5. Let dry
6. Screw one side of each hinge to the assembled **Bump Out** using the pre-drilled holes on the **Left Panel**.
7. Screw the other side of each hinge to the **Left Wall** using the pre-drilled holes.
8. Glue a magnet into the magnet hole on the **Right Panel**. Glue the other magnet into the magnet hole on the **Left Wall** or wait to do so until you have finished the **Shell's** exterior, in which case you will need to drill a magnet hole into the finished surface.

